



**Dramatic  
Asthma  
Relief**

**Breathe Freely  
Enjoy An  
Active Life  
with...**

# Tropum

Ipratropium Bromide

Ipratropium Nebuliser Solution BP

0.025%

5 single doses of  
2ml, filled in 5ml  
**PLASTIC AMPOULES**



**FREEDOM FROM DISTRESSING  
SYMPTOMS OF BRONCHOSPASM**

*Associated with....*

*Chronic Obstructive Pulmonary  
Disease (COPD) Including  
(Chronic Bronchitis, Emphysema)*

**&**

***Asthma***

*Short acting Bronchodilator that shows  
significant improvement in FVC compared  
with placebo.*

*Can be used as first line drug for the treatment  
of stable patients with COPD*

# Tropum

Ipratropium Bromide

Ipratropium Nebuliser Solution BP

0.025%

5 single doses of  
2ml, filled in 5ml  
**PLASTIC AMPOULES**

Manufactured  
through Latest BFS  
**(Blow-Fill-Seal)**  
Technology  
Acknowledged by  
**FDA**



FDA and the united states pharmacopoeia, characterizes BFS technology as an **“Advanced aseptic process”** indicating it as preferred technology, especially in the ophthalmic and respiratory market.



Available  
in a  
**Re-sealable  
POUCH**

## **INSTRUCTIONS FOR USE:**

**Operate as follows, to use the unit dose ampoule:**

1. Bend the vials in two direction as shown in figure (A)
2. Separate the vial from the strip at the tops and then in the centre of the ampoule (see figure B)
3. Open the ampoule by twisting the closure at the top (see figure C)
4. Gently squeeze the ampoule to drop the drug at the prescribed dose (see figure D)



A

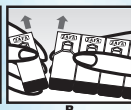

B



C

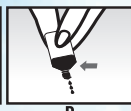

D

# Tropum

## Ipratropium Bromide

Ipratropium Nebuliser Solution BP

0.025%

5 single doses of  
2ml, filled in 5ml  
**PLASTIC AMPOULES**



### DOSAGE:

#### Adult:

0.25mg-0.5mg (1-2ml or 16-32 drops approx) 3-4 times a day with doses 6-8 hours apart.

#### Children: 6-12 years:

0.25mg (1ml or 16 drops approx) 3-4 times a day. Max 1mg daily with doses 6-8 hours apart.

#### Under 5 years:

0.125mg-0.25mg (0.5ml-1ml or 8-16 drops approx) 3-4 times a day. Max 1mg daily, with doses 6-8 hours apart.

### Brief Prescribing Information:

COMPOSITION: Each single dose ampoule of 2ml contains Ipratropium Bromide 0.50mg in purified water filled in 5ml plastic ampoule. PHARMACOTHERAPEUTIC CATEGORY: Antiasthmatic drug for inhalation with anticholinergic activity. MODE OF ACTIONS: Ipratropium Bromide is an anticholinergic (Parasympatholytic) agent. It antagonizes the action of acetylcholine. There by producing bronchodilation. INDICATIONS: Bronchospasm associated with chronic obstructive pulmonary disease, including bronchitis & emphysema. CONTRAINDICATIONS: Not recommended in patient with glaucoma, hypertrophy of the prostate, urinary retention disease and intestinal occlusion. Also contraindicated in known or suspected cases of hypersensitivity to Ipratropium Bromide. INSTRUCTIONS FOR USE: Operate as follows, to use the unit dose ampoule: 1. Bend the vials in two direction as shown in figure (A) 2. Separate the vial from the strip at the tops and then in the centre of the ampoule (see figure B) 3. Open the ampoule by twisting the closure at the top (see figure C) 4. Gently squeeze the ampoule to drop the drug at the prescribed dose (see figure D) PRECAUTIONS: Ipratropium Bromide should cautiously administered in patient with coronary and heart diseases. The prescribed dose should not be modified, and in case no therapeutic effect occurs, the physician must be informed, who will advice accordingly. It should be taken into account that it takes about 3-5 minutes to start getting therapeutic effect. OVER DOSE: Acute systemic overdosage by inhalation is unlikely since **Tropum** (Ipratropium Bromide) is low absorbed after inhalation at upto four fold the recommended dose. STORAGE: **Tropum** Nebuliser Solution should be stored between 15-30°C protected from light, since exposure to light can affect the efficacy of the product. The unused ampoules should always be stored at the recommended temperature in the specially supplied aluminum pouch. Keep all medicines out of the reach of children. SPECIAL WARNINGS: As for other nebuliser administration, rare reports of paradoxical bronchospasm may occur. In this case, immediately withdraw administration and institute proper therapy. Should the drug accidentally come into contact with eyes, accommodation disturbances, in any case mild and transient, may occur, even if rarely. Pregnancy and breast-feeding. In ascertained or suspected pregnancy the drug should be used cautiously and under strict medical surveillance. To be sold by retailer on the prescription of a registered medical practitioner only. HOW SUPPLIED: 5 ampoules of **Tropum** 0.025% (Ipratropium Nebuliser Solution BP) 2ml, filled in 5ml ampoules, packed in an aluminum pouch in an individual carton.



## 'Medicines For All'



**ZAFa Pharmaceutical Laboratories (Pvt) Limited.**

L-1/B, Bjock-22, FEDERAL 'B' INDUSTRIAL AREA, KARACHI-75950 (PAKISTAN)  
Email: zafaph@cyber.net.pk. Website: www.zafa.com.pk



ISO 9001:2000